

This is our installation guide for our freestanding **Cylinder with tray.**

Cylinder with tray kit

Your selected
concrete basin
(design varies per basin)

Box 1

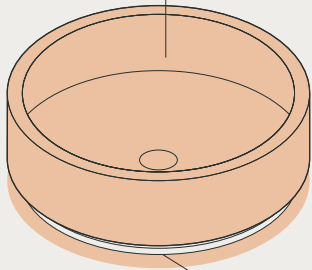

Do not place tools, taps and mixers inside or near the basin, cylinder or tray at any time.

Damage inflicted by doing so is not covered by our warranty.

Connector ring

Box 2

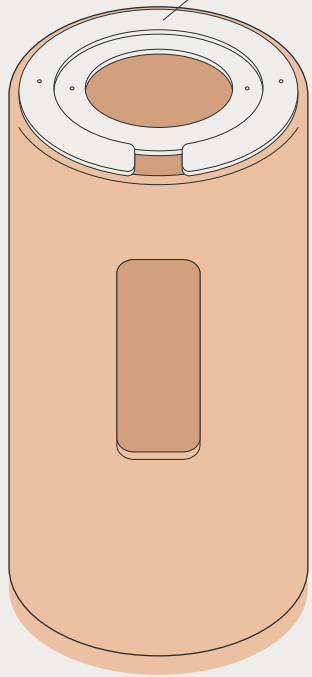

Box 3

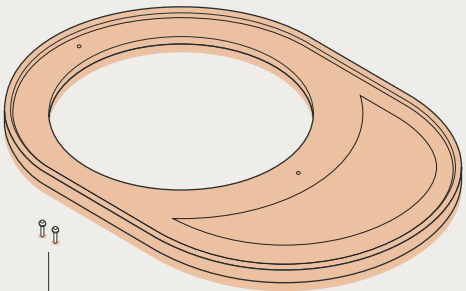

Bolts



Allen Key



Adjustable feet

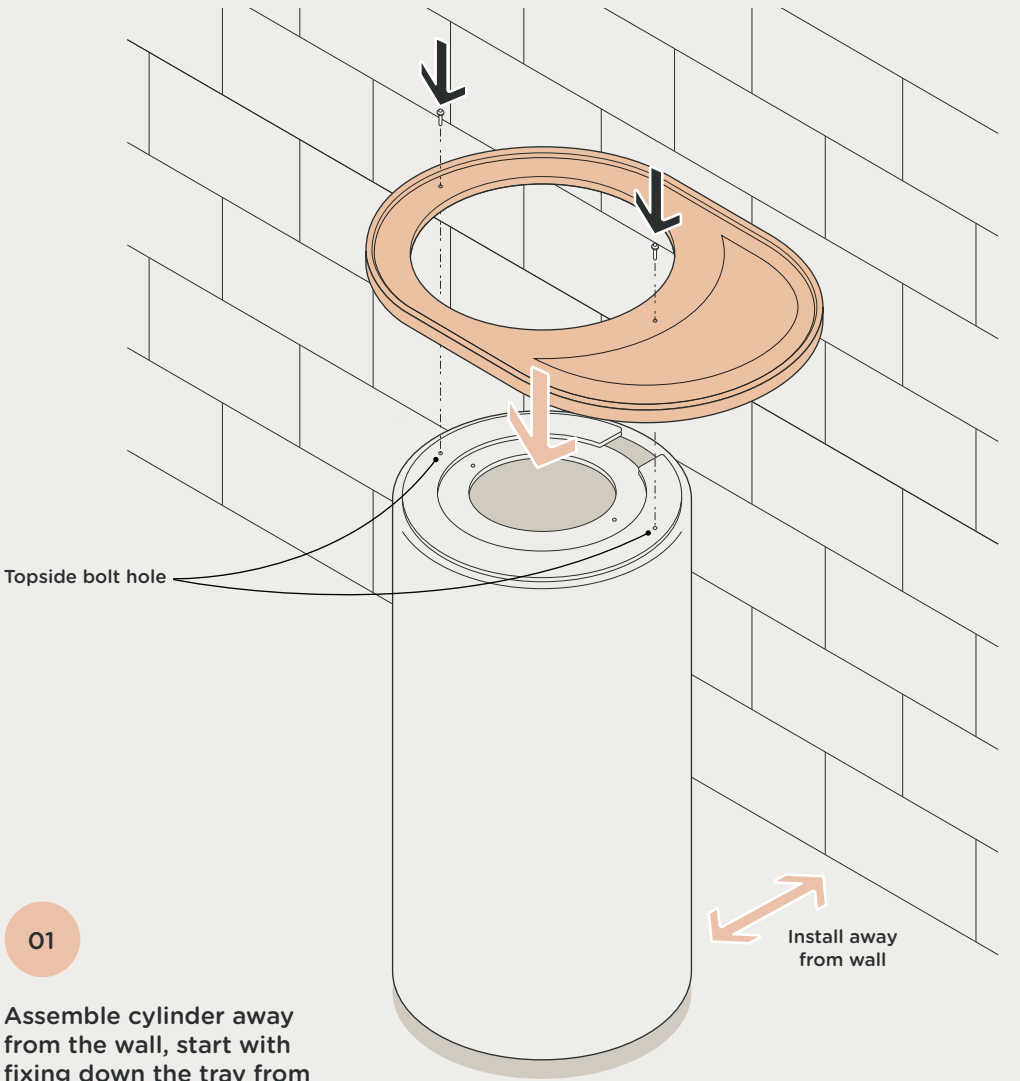

01

Assemble cylinder away from the wall, start with fixing down the tray from the top with bolts provided.

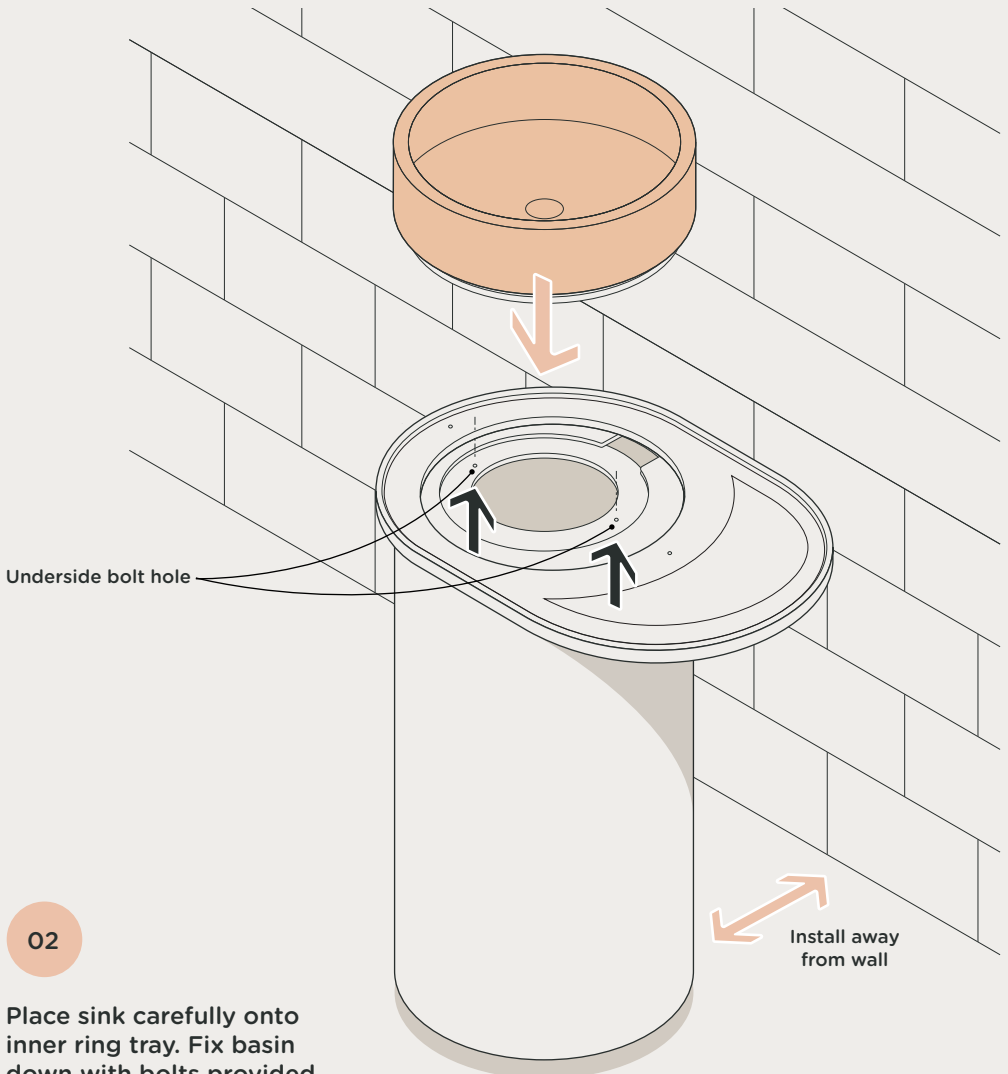

02

Place sink carefully onto inner ring tray. Fix basin down with bolts provided (accessed from underside).

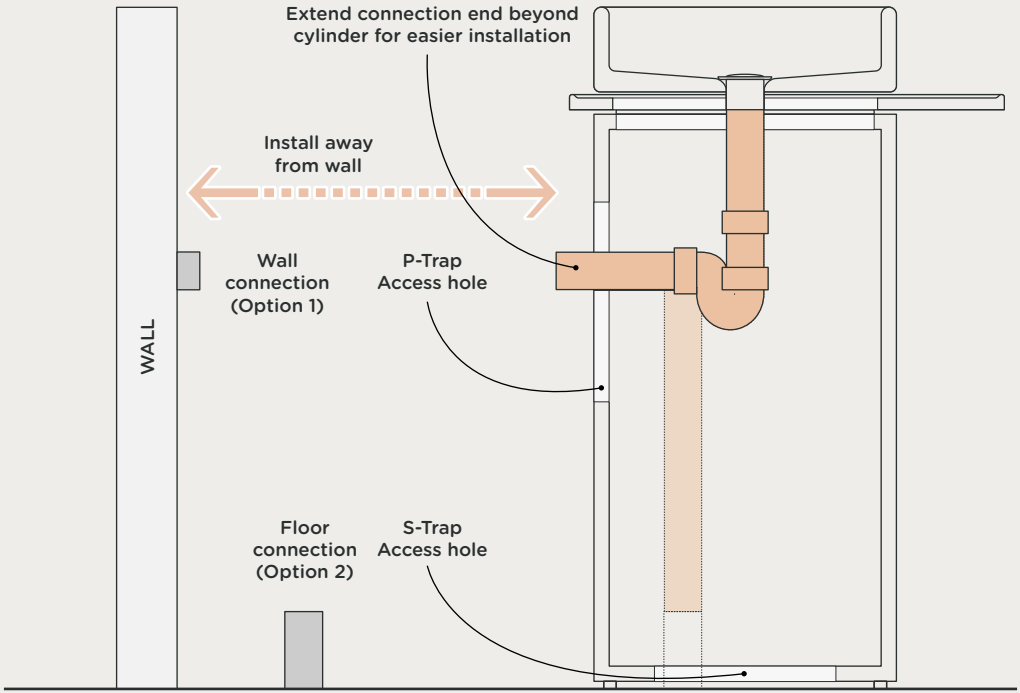

03

Access holes are provided for both S-Trap and P-Trap configurations. Connect specified trap to basin waste within cylinder cavity. Extend trap connection beyond cylinder to allow for easier installation.



Do note the cylinder does not sit flush against the wall to allow for hand access.

See also: Step 05.

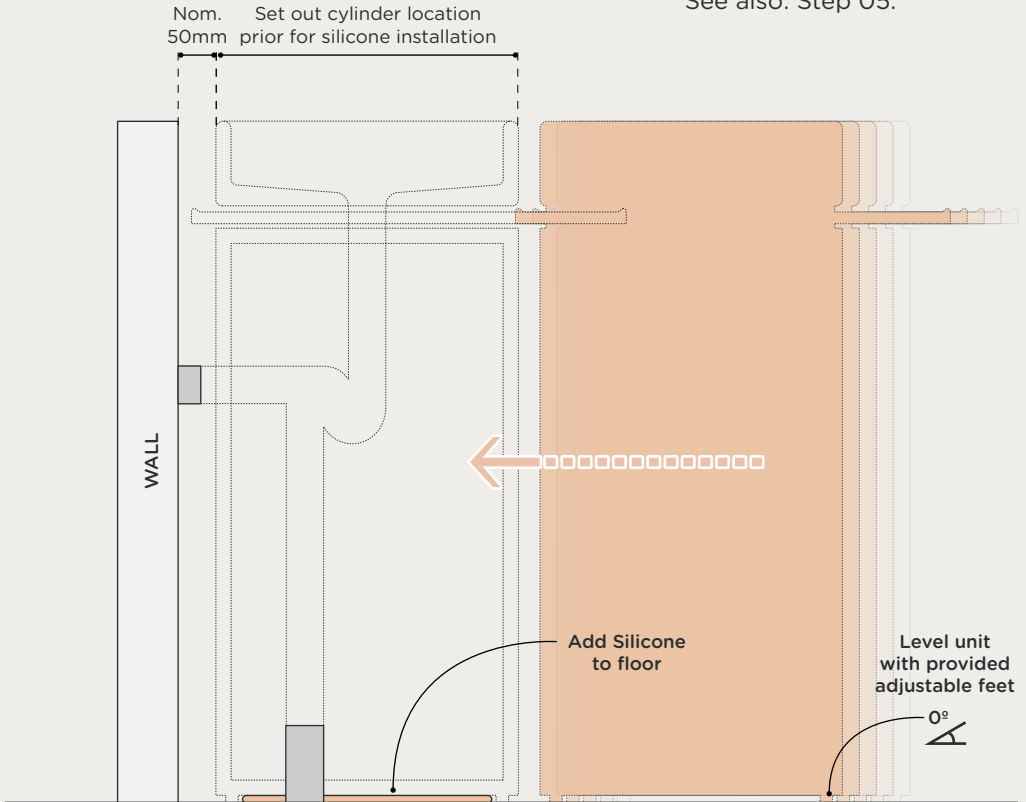

04

Level cylinder with provided adjustable feet. Add clear Silicone to the floor of the proposed location of the cylinder base.

Move cylinder into place with two people.

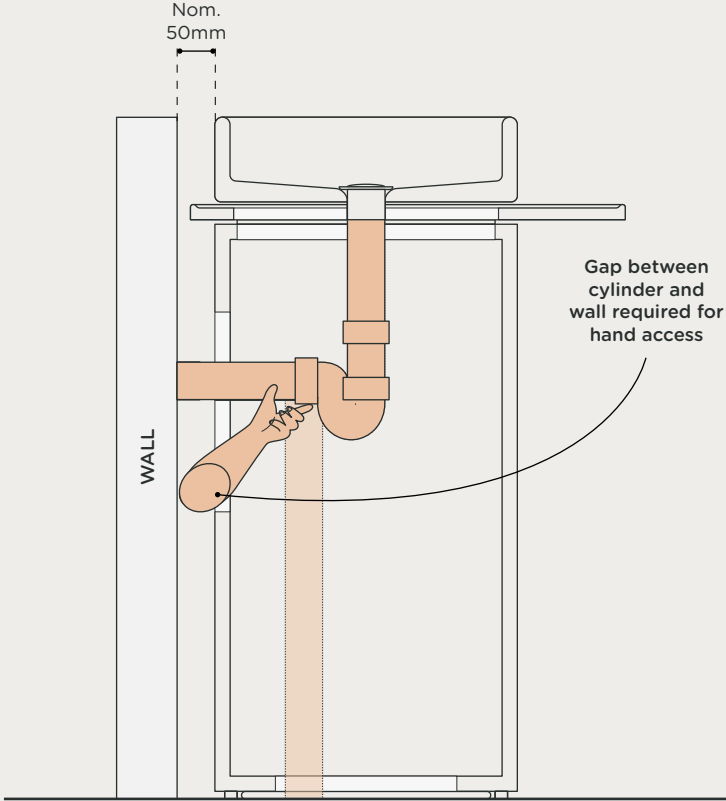

05

Connect waste to compliant flexible pipe via access hole in back of cylinder.

Got a question? Drop us a line, we're here to help!

info@noodco.com.au

noodco.com.au